

ML-605M Series Electro-Mechanical Lock Installation Instruction

Specification

- Operating Voltage: 12~24VDC/AC $\pm 10\%$
- Current Draw: 250mA/12VDC; 150mA/24VDC
- Operating Temperature: 14°F to 120°F (-10°C~+49°C)
- Humidity: 0~85% non-condensing
- Version Changeable: Fail-safe or Fail-secure
- Lock bolt sensor switch output: SPDT, 3A/125VAC
- Latch Throw: 16mm
- Solenoid testing: Tested to 250,000 cycles
- Resistance against door being forced :
1500 lbs (static force); 70 ft-lbs (dynamic force)
- Backset:
ML-605M-30: 30mm
ML-605M-35: 35mm

Dimension

Unit: mm

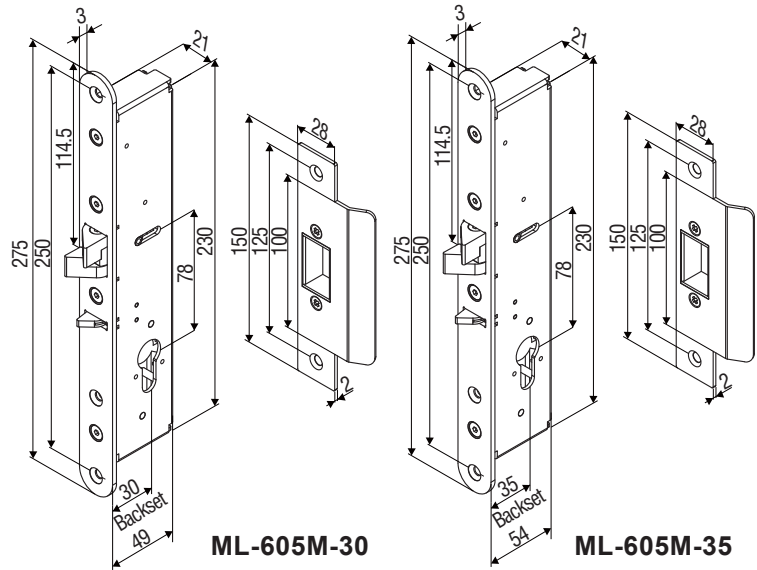

Packing Contents

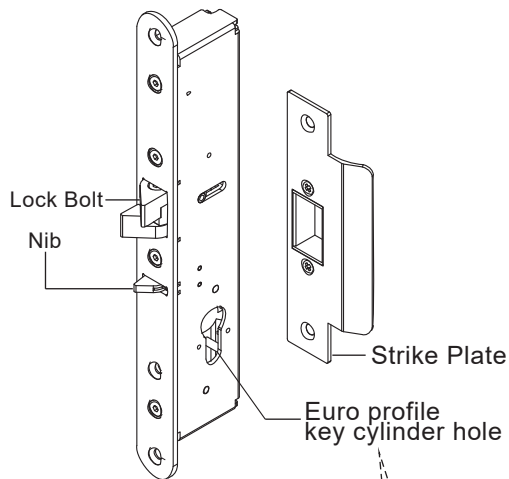

Version Changeable:

Take out the Screw 1, release screw 2, move the position and then tighten both screws.

"Fail-Safe"
(Power to Lock)

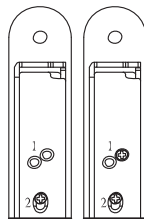
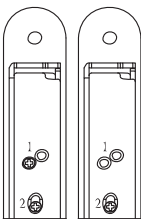

"Fail-Secure"
(Power to Open)

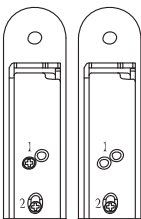
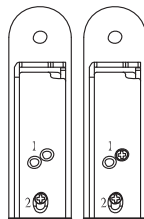

⚠ Caution:

Do not completely remove screw 2 (as marked in the figure) as the interior solenoid might fall off.

Stud Bolt Position

For fail-safe mode

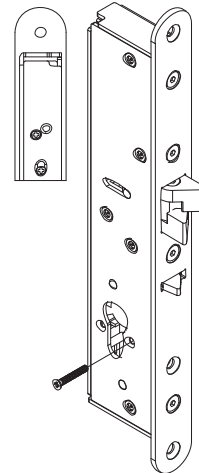

For fail-secure mode

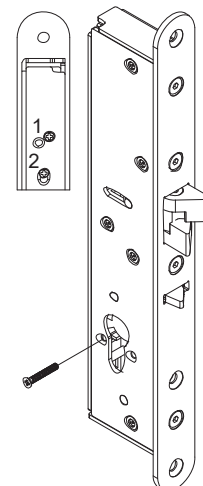

Installation Instructions

62mm cylinder for max · 42mm door leaf
72mm cylinder for max · 52mm door leaf

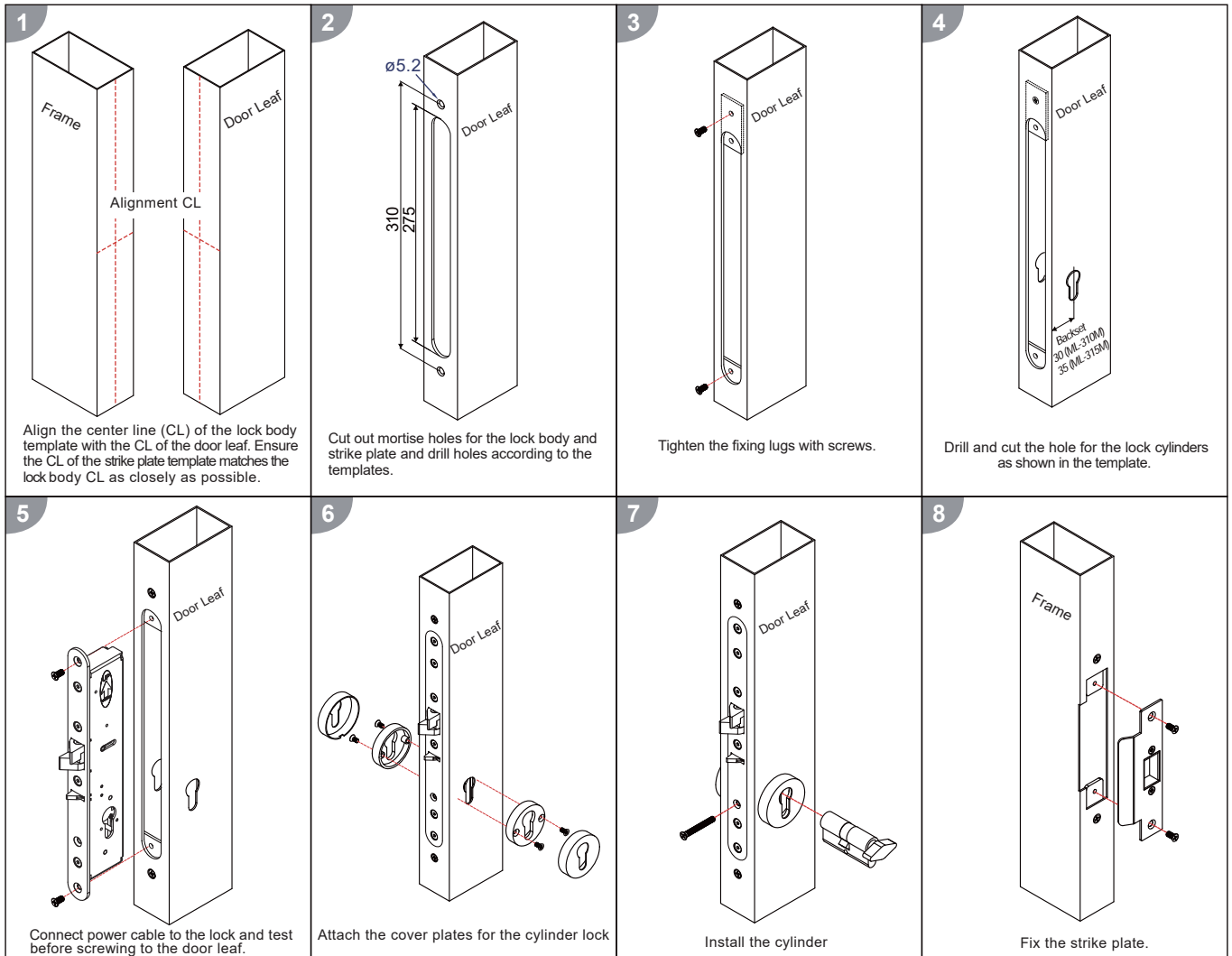
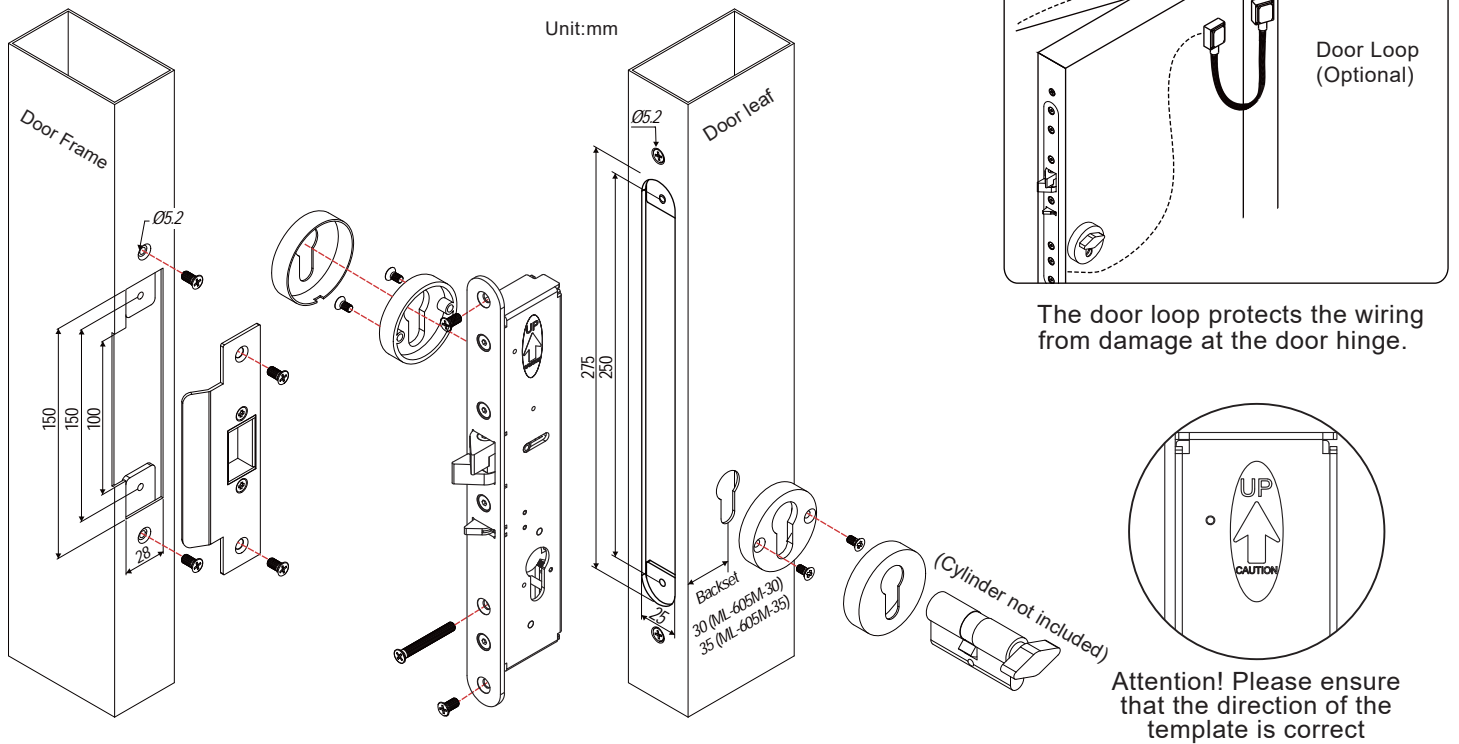

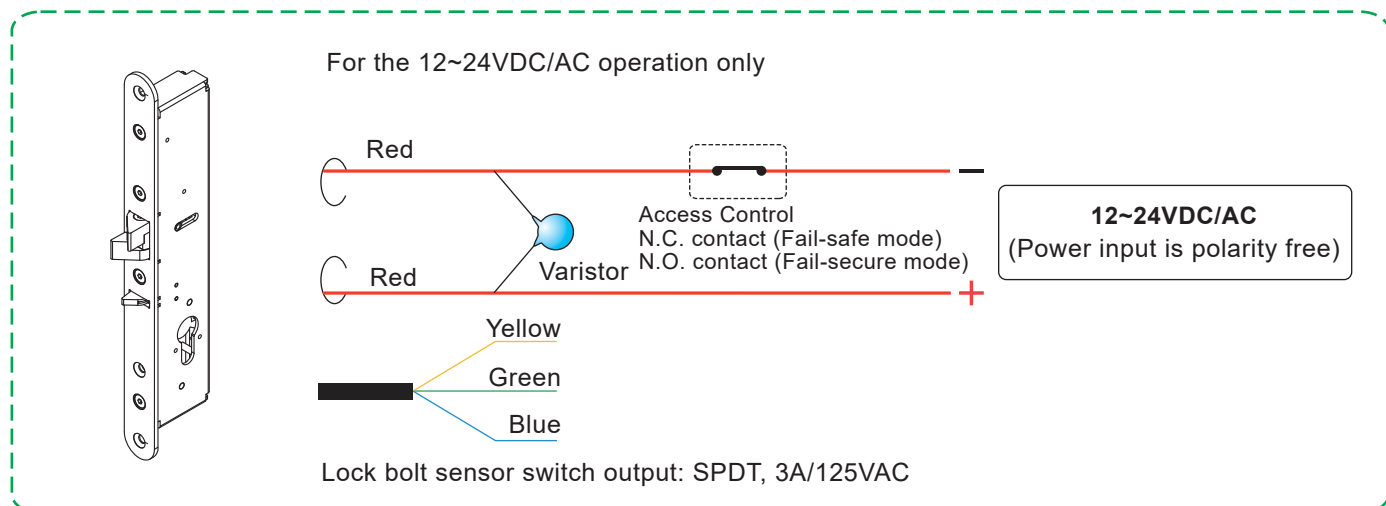

NOTE: The varistor (or diode) must be connected across the terminals as shown above. This protects the electromechanical lock from spikes and surges.

Butt Splice (IDC) Connector

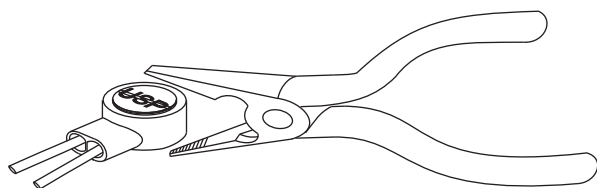

Using crimper or pliers and pressing the header of connector down to even position.