

Outswing doors with a narrow frame/header

L-AXM-D800AU Bracket

The A value in the table below shows the minimum required depth of the door frame for different electromagnetic lock models.

Magnet Grade	A Value	Optional Brackets
● 800 LBS	48 mm	L-AXM-D800AU
1200 LBS	60 mm	L-AXM-D1200AU

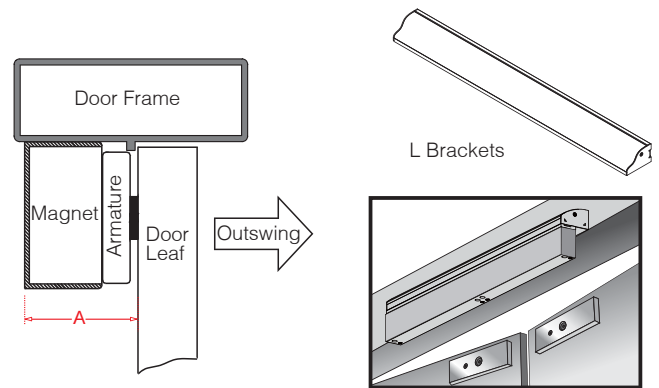

Applicable model (s): AXM-D800 Series

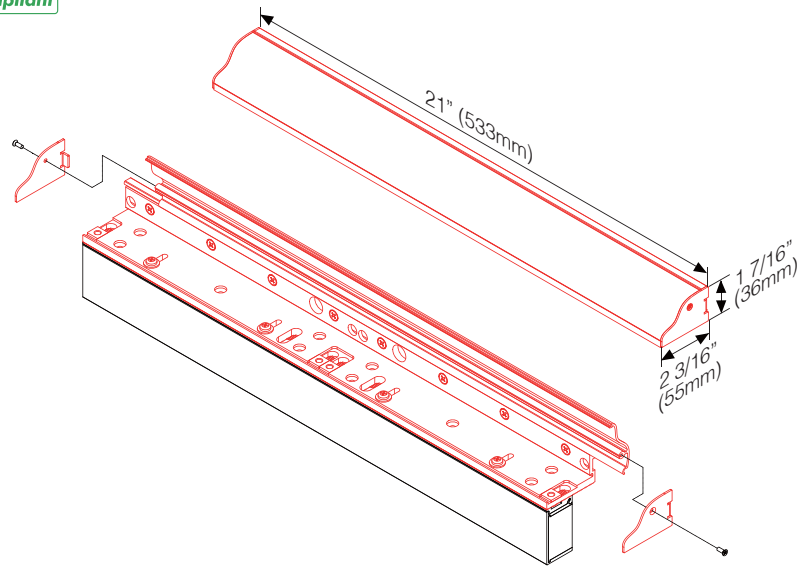

Installation of an L Bracket on Outswing Doors

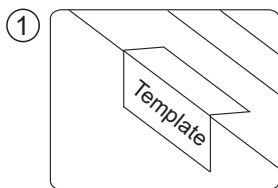

① Fold the mounting template 90° angle along the dotted line.

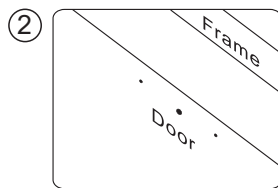

② Drill the holes marked on the template.

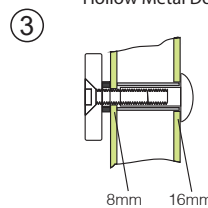

③ Hollow Metal Door
Drill a hole 8 mm in diameter through the door. Enlarge the hole to 16 mm from outside.

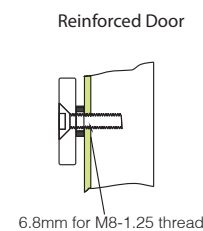

③ Reinforced Door
Drill a hole 6.8mm in diameter from inside. Screw with a M8-1.25 thread.

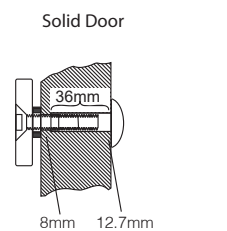

③ Solid Door
Drill a hole 8mm in diameter through the door. Enlarge the hole to 12.7mm from outside. The thickness of the door is 36mm.

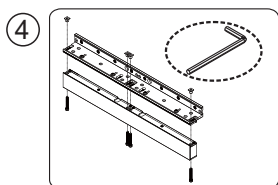

④ Assemble the electromagnet and L bracket with an Allen wrench.

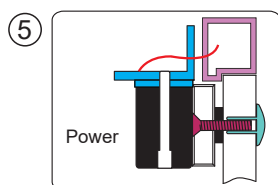

⑤ Connect the lock wire to a power source. Let the electromagnet and the armature plate bond together. Press L bracket against the door frame.

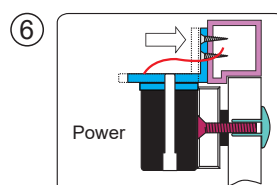

⑥ Fasten the L bracket on the door frame.

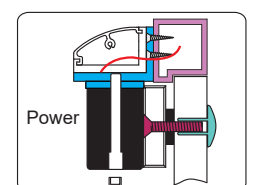

⑥ Bench test the unit to complete installation